

SECTIONAL SIDE VIEW

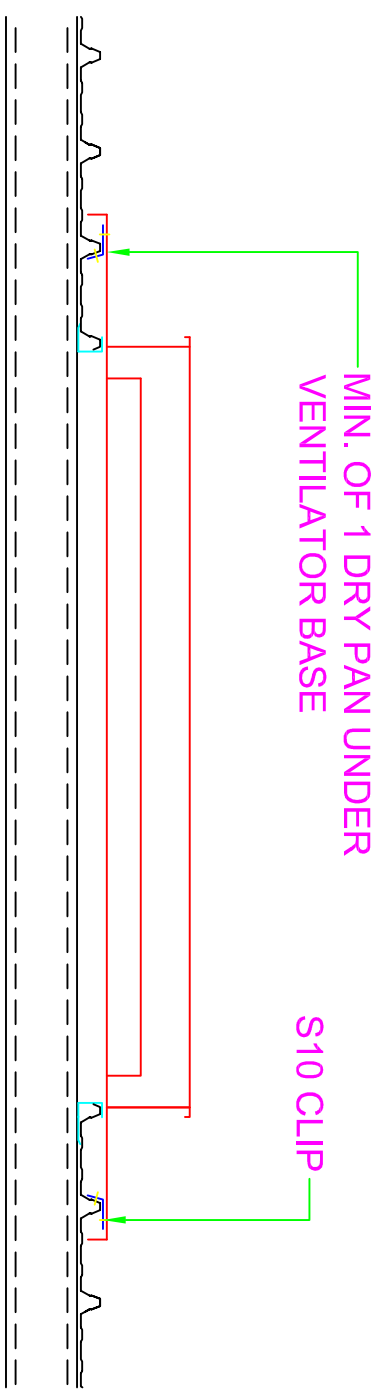

SECTION A-A

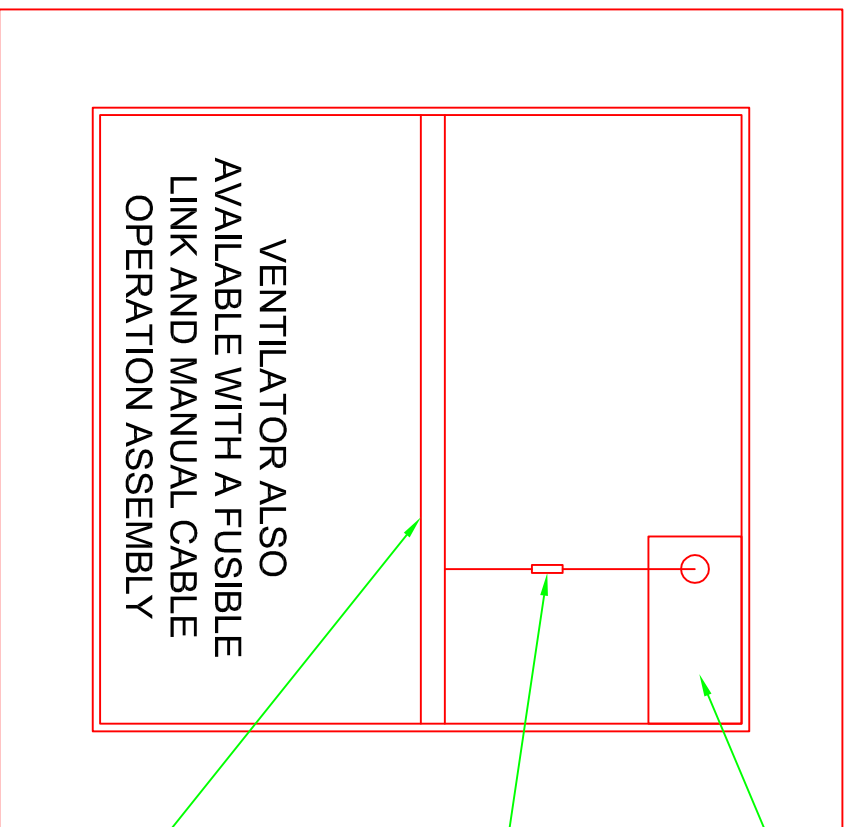

FAILSAFE ACTUATOR. AVAILABLE IN 230V OR 24V DEPENDANT ON THE APPLICATION

FUSIBLE LINK, DESIGNED TO SEPARATE AND ALLOW THE VENTILATOR TO OPEN AT A SET TEMPERATURE

CONTROL BAR FOR OPENING AND CLOSING THE VENTILATOR BLADES

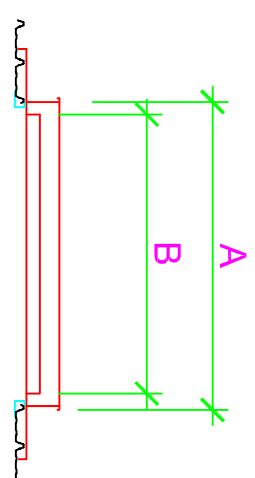

FRONT VIEW

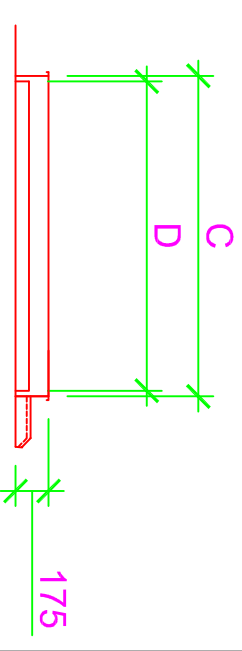

SIDE VIEW

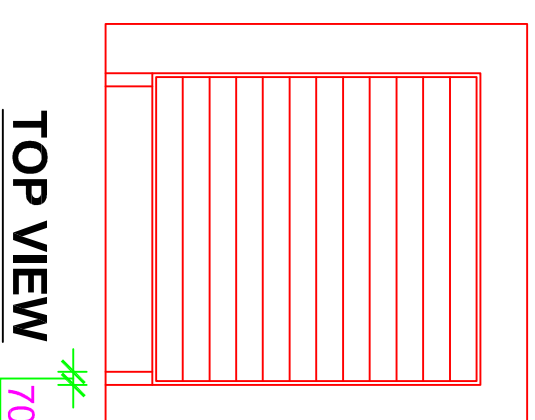

TOP VIEW

BASE MAY BE MANUFACTURED ACCORDING TO CERTAIN SITE SPECIFIC APPLICATIONS AND REQUIREMENTS

- A- BODY WIDTH
- B- THROAT WIDTH (MAXIMUM OF 2000mm)
- C- BODY LENGTH
- D- THROAT LENGTH

VIEW FROM BELOW VENTILATOR

DRAWING No.	HELM-ARV-001
DRAWING ISSUED FOR	INFORMATION
CHECKED/DRAWN BY	DO/TV
ENGINEER	.
MAIN CONTRACTOR	.
CONTRACT NUMBER	.
CONTRACT NAME	.
SCALE	NOT TO SCALE
DATE DRAWN	27-10-2011



284 DEKEMA ROAD
WADEVILLE
GAUTENG
P.O. BOX 14003
WADEVILLE 1428
TEL: 086 111 4356
FAX: 086 749 2709



LEVEL 2 B-BBEE CERTIFIED

THIS DRAWING AND THE INFORMATION IT CONTAINS IS THE PROPERTY OF HELM ENGINEERING (PTY) LTD AND MAY NOT BE REPRODUCED IN ANY WAY WITHOUT PRIOR WRITTEN CONSENT FROM THE COMPANY

SMOKE VENTILATION

NOTES:
ARV AVAILABLE WITH THE FOLLOWING MATERIAL CODES
GBGB: GALVANIZE BODY, GALVANIZE BLADES
GBAB: GALVANIZE BODY, ALUMINIUM BLADES
ABAB: ALUMINIUM BODY, ALUMINIUM BLADES
ZBZB: ZINCALUME BODY, ZINCALUME BLADES
ZBAB: ZINCALUME BODY, ALUMINIUM BLADES
CBCB: CHROMADEK BODY, CHROMADEK BLADES
ARV CAN ALSO BE PAINTED / POWDER COATED TO SPECIFICATION

TITLE

**HELM ARV
(AUTOMATIC RELEASE
VENTILATOR)**

REV NO.	CHANGES MADE /ISSUE SHEETING DETAILS ADDED
1	
2	CONTACT DETAILS